

[www.blackanddecker.co.uk](http://www.blackanddecker.co.uk)

**BXEH60016GB**

### What's in the box

Instruction Manual  
12L Smart Dehumidifier  
Drainage Hose

### Features

- |                  |                         |
|------------------|-------------------------|
| 1. Control panel | 5. Drainage hose outlet |
| 2. Handle        | 6. Water tank           |
| 3. Air outlet    | 7. Air inlet            |
| 4. Cord storage  |                         |

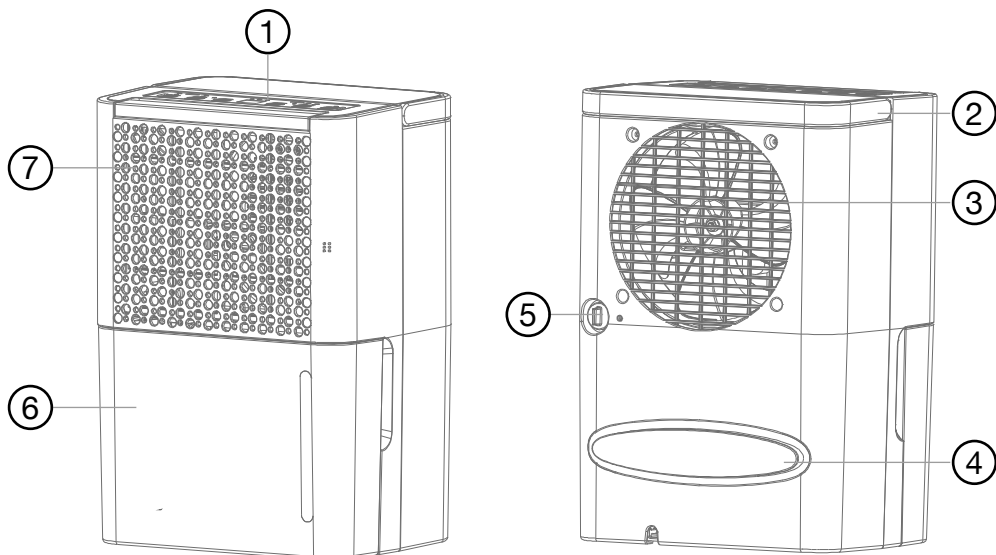

### Control Panel

- |                                         |                                       |
|-----------------------------------------|---------------------------------------|
| 1. Defrost indicator                    | 9. Timer button and indicator         |
| 2. WiFi Indicator                       | 10. Time/Humidity Down button         |
| 3. Tank Full Indicator                  | 11. LED display and indicators        |
| 4. Continuous mode indicator            | 12. Time/Humidity Up button           |
| 5. Auto mode indicator                  | 13. Mode button and indicators        |
| 6. Dry clothes mode indicator           | 14. Power On/Off button and indicator |
| 7. Ventilation mode indicator           |                                       |
| 8. Speed selection button and indicator |                                       |

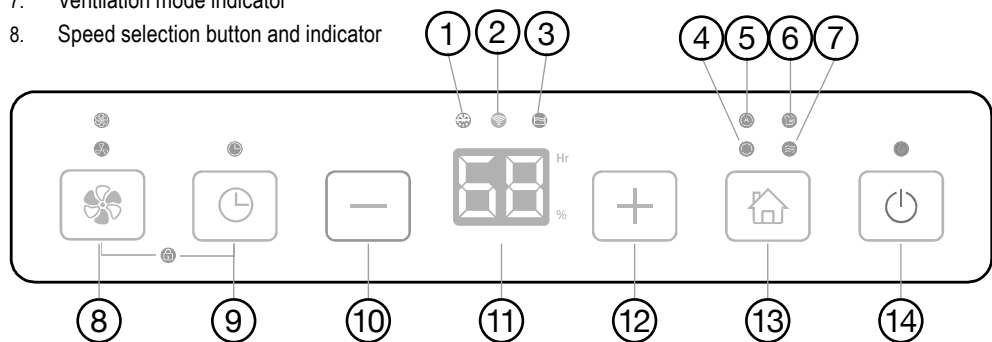

### Intended Use

Your BLACK+DECKER BXEH60016GB 12L Smart Dehumidifier has been designed for small and medium spaces.

This appliance is intended for indoor household use only.

Thank you for choosing BLACK+DECKER. We hope that you will enjoy using this product for many years.

### Safety Instructions

**▲WARNING:** Read all safety warnings and all instructions. Failure to follow the warnings and instructions listed below may result in electric shock, fire and/or serious injury.

- ◆ Read this manual carefully before using the appliance.
- ◆ The intended use is described in this manual.
- ◆ If the supply cord is damaged, it must be replaced by the manufacturer, its service agent or similarly qualified persons in order to avoid a hazard.
- ◆ The use of any accessory or attachment or the performance of any operation with this appliance other than those recommended in this instruction manual may present a risk of personal injury.
- ◆ Retain this manual for future reference.
- ◆ **▲WARNING:** When using mains-powered appliances, basic safety precautions, including the following, should always be followed to reduce the risk of fire, electric shock, personal injury and material damage.

### Using Your Appliance

Please read the operating instructions carefully before using your appliance for the first time.

- ◆ Check that the voltage of the main circuit corresponds with the rating of the appliance before operating.
- ◆ Children shall not play with the appliance.
- ◆ DO NOT let the cable hang over the edge of a table or counter or let it come into contact with any hot surfaces.
- ◆ The use of accessory attachments is not recommended by the appliance manufacturer, apart from those supplied with this product.
- ◆ DO NOT pull the plug out by the cable as this may damage the plug and/or the cable.
- ◆ DO NOT use this product for anything other than its intended use.
- ◆ This appliance is for household use only.
- ◆ DO NOT carry the appliance by the power cable.
- ◆ DO NOT use the appliance outdoors.
- ◆ DO NOT operate with wet hands.
- ◆ Use of an extension cable with this appliance is not recommended. However, if it is necessary to use an extension lead, ensure that the lead is suited to the power consumption of the appliance to avoid overheating of extension

cable, appliance or plug point. DO NOT place the extension cable in a position where it can be pulled on by children or animals or tripped over.

- ◆ Always unplug the unit when not in use or before cleaning.
- ◆ The manufacturer does not accept responsibility for any damage or injury caused by improper or incorrect use, or for repairs carried out by unauthorised personnel.

### Safety Of Others

- ◆ Close supervision is necessary when any appliance is used by or near children.
- ◆ Children should not play with the appliance.
- ◆ This appliance can be used by children aged from 8 years and above and persons with reduced physical, sensory or mental capabilities or lack of experience and knowledge if they have been given supervision or instruction concerning use of the appliance in a safe way and understand the hazards involved.
- ◆ Cleaning and user maintenance should not be undertaken by children without supervision.
- ◆ Take care when any appliance is used near pets.
- ◆ DO NOT allow the cord to become twisted.

### After Use

- ◆ While cleaning, DO NOT use a wet cloth or use water on any part of the unit, as this may cause a short circuit or electrical shock.
- ◆ Keep this unit clean. DO NOT allow objects to enter the ventilation opening as this may cause electric shock, or damage to the unit. Switch off the unit and then remove the plug from the socket when not in use or before cleaning.
- ◆ Check all inlets and outlets regularly for accumulated dust.
- ◆ Disconnect the unit from mains outlet when it is not in use, or before relocating or cleaning it.
- ◆ Switch off and remove the plug from the socket before leaving the appliance unattended and before changing, cleaning or inspecting any parts of the appliance.
- ◆ When not in use, the appliance should be stored in a dry place. Children should not have access to stored appliances.

### Inspections And Repairs

- ◆ DO NOT attempt to dismantle, repair or remould any part of the unit. This should only be done by a qualified service agent.
- ◆ In the unlikely event the appliance develops a fault, stop using it immediately and seek advice from the manufacturer.

- ◆ In case of technical problems, switch off the product and DO NOT attempt to repair it yourself. Return the appliance to an authorised BLACK + DECKER service facility for examination, adjustment or repair. Always insist on the use of original spare parts. Failure to comply with the above mentioned precautions and instructions, could affect the safe operation of this product. Further information about authorised BLACK + DECKER service facilities can be found on [www.2helpu.com](http://www.2helpu.com)

### Additional safety instructions for Dehumidifiers

- ◆ Always operate the appliance on a smooth, even, stable surface. DO NOT place the unit on a hot surface.
- ◆ Ensure that the unit is switched off after use.
- ◆ DO NOT immerse cables, plugs or any part of the appliance in water or any other liquid.
- ◆ Operate the unit only at the voltage specified.
- ◆ DO NOT use the unit near open windows, as contact with rain and other natural elements could cause an electrical hazard
- ◆ DO NOT put heavy objects on the appliance.
- ◆ DO NOT tip the unit on its side.
- ◆ Never insert any other object into the unit body to avoid any hazard or unit failure.

- ◆ DO NOT put the unit close to heat-generating devices or near flammable and dangerous materials.
  - ◆ The appliance must be positioned so that the plug is accessible.
- ⚠ WARNING:** DO NOT place the unit near a gas or electric heat source.
- ◆ When placing the unit, take care to observe the distances from floors, ceilings and other appliances shown in the figure below.

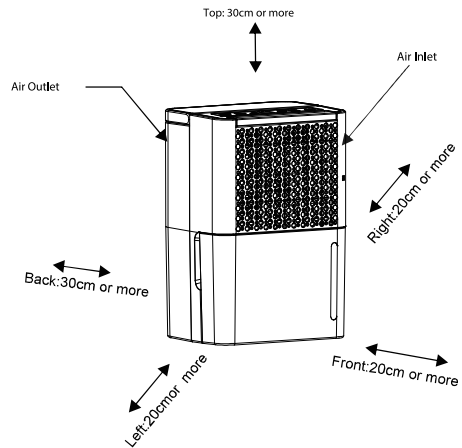

### Safety relating to refrigerant R290:

- ◆ These symbols on your device mean:
- ◆ This appliance is filled with Propane gas R290. ALWAYS follow the manufacturer's instruction concerning use and repairs.
- ◆ Read the entire instruction manual carefully before attempting to use the appliance.
- ◆ DO NOT install, operate or store the device in a room smaller than 4m<sup>2</sup>.



Warning: Risk of fire



Please read operator's manual carefully!



Please read operating instructions carefully!



Please read technical manual carefully!

- ◆ Read these warnings carefully.
- ◆ This appliance contains approximately 40g of R290 refrigerant. R290 is a refrigerant that complies with the relevant European Directives. Never perforate the refrigerant circuit.

### CAUTION: R290 is flammable (GWP3)!

- ◆ DO NOT use any processes to clean the unit or accelerate the defrosting process, other than those recommended by the manufacturer.
- ◆ DO NOT store the appliance in a room containing continuously operating ignition sources (for example: open flames, an operating gas appliance or an operating electric heater).
- ◆ DO NOT pierce or burn DO NOT set the unit on fire.
- ◆ Take care to store the appliance in such a way as to prevent mechanical faults or damage from occurring.
- ◆ DO NOT install, operate or store the appliance in a room with a floor area of less than 4m<sup>2</sup>.
- ◆ Be aware that the refrigerant may be odourless, and that leaks may not be detectable by smell.

- ◆ ALWAYS take care to comply with national gas regulations.
- ◆ Keep ventilation openings clear of obstruction.
- ◆ An unventilated area where the appliance is used should be constructed so that, should the refrigerant leak, it should not stagnate as to create a fire or explosion hazard.
- ◆ Store the appliance in a well-ventilated area where the room size corresponds to the room area specified for operation.
- ◆ Any person who is involved with working on or breaking into a refrigerant circuit should hold a current valid certificate from an industry-accredited assessment authority, which authorises their competence to handle refrigerants safely in accordance with an industry recognised assessment specification.
- ◆ Servicing shall only be performed on the grounds recommended by the equipment manufacturer. Maintenance and repair requiring the assistance of other skilled personnel shall be carried out under the supervision of the person competent in the use of flammable refrigerants.

**▲WARNING:** DO NOT place the unit on or near a hot gas or electric burner.

## Electrical safety



This product must be earthed. Always check that the mains voltage corresponds to the voltage on the rating plate.

- ◆ Appliance plugs must match the outlet. Never modify the plug in any way.
- ◆ DO NOT use any adaptor plugs with earthed (Class I) appliances. Unmodified plugs and matching outlets will reduce the risk of electric shock.
- ◆ To avoid the risk of electric shock, DO NOT immerse the cord, plug or appliance in water or other liquid.

## Extension cables & class I product

- ◆ A 3 core cable must be used as your tool is earthed and of class I construction.
- ◆ Up to 30m (100 ft) can be used without loss of power.
- ◆ If the supply cord is damaged, it must be replaced by the manufacturer or an authorised BLACK+DECKER Service Centre in order to avoid a hazard.

**Warning!** Before assembling, switch the appliance off and remove the plug from the socket.

## Features

1. Control panel
2. Handle
3. Air outlet
4. Cord storage
5. Drainage hose outlet
6. Water tank
7. Air inlet

## Control Panel

1. Speed selection button and indicator
2. Timer button and indicator
3. Time/Humidity Down button
4. LED display and indicators
5. Time/Humidity Up button
6. Mode button and indicators
7. Power On/Off button and indicator

## Use

### About the Controls

- ◆ 4 Operational Modes: Automatic, Continuous Dehumidifying, Drying Clothes and Ventilation
- ◆ 2 fan speed settings
- ◆ 24-hour timer
- ◆ WiFi functionality
- ◆ Child lock function

## Before First Use

**Note:** Read all instructions and safety information carefully before first use. Please retain this information for future reference.

- ◆ Remove your appliance from the packaging.
- ◆ Check that there is no damage to the cord or any visible damage to the body.
- ◆ Dispose of the packaging in a responsible manner.
- ◆ DO NOT delete the rating label or the label containing the "caution: risk of fire" and "read the manual" symbols
- ◆ Wipe the outside of the appliance with a damp cloth.
- ◆ Situate your appliance according to the Safety Instructions section.

## Turning the Unit ON or OFF

- ◆ To use the appliance, begin by plugging it into a compatible mains socket, ensuring the socket switch is in the ON position. There will be a sound prompt when the dehumidifier is in standby.
- ◆ Once the unit is plugged in, press the Power On/Off button to turn the unit on. The corresponding indicator will illuminate and the unit's LED display will come on.
- ◆ Press the Power On/Off button again while the unit is in operation to turn it off. The corresponding indicator and the unit's LED display will go out and the unit will stop operating after a few seconds.

## Dehumidifying Mode Selection

This unit is equipped with a choice of 4 dehumidifying modes: Automatic, Continuous, Clothes Drying and Ventilation.

- ◆ Repeatedly press the Mode button to cycle through and select the desired dehumidification mode. The corresponding indicator will illuminate.
- ◆ Press the Mode button again at any time while the unit is in operation to select a different mode. The corresponding indicator will illuminate, and the unit will begin to operate in the newly selected mode after a few seconds.
  - Ventilation Mode: Built-in Ioniser and dust filter helps removes particles from airflow for refreshing clean air.
  - Dry Clothes Mode: Dry clothes faster by extracting moisture from the environment, preventing musty odours within cupboards and rooms.
  - Continuous Mode: Set to automatically extract moisture from the environment at a low fan speed
  - Auto Mode: Choose between fast or slow dehumidifying and set the exact humidity level required between 30-80%

## Setting a Timer

This unit is equipped with timer and delay timer functions of up to 24 hours.

### Setting a Delay Timer:

- ◆ Press the Timer button when the unit is on Standby mode to activate the delay timer selection mode. The Timer, Fan Speed and Mode indicators will light up.

- ◆ When the delay timer function is active, press the Time/Humidity Up and Down on the unit's control panel to cycle through and select the available timers, from 1 to 24 hours.
- ◆ Once the required timer has been set, select the desired operational mode, as described in the section opposite. If operating in Auto Mode, use the Speed selection button to set the required fan speed and the + and - keys on the unit's control panel to set the required humidity level.
- ◆ The timer digits will flash for a few seconds on the unit's LED screen, after which the control panel will go out, but the Timer indicator will remain lit to show the delay timer is active.
- ◆ Once a timer option is selected, the unit will automatically delay its operation for the selected period of time, then turn itself on when it elapses.

### Setting a Timer

- ◆ Alternatively, press the Timer button when the unit is on to activate the standard timer selection mode.
- ◆ When the timer function is active, press the Time/Temperature Up and Down keys on the unit's control panel to cycle through and select the available timers, from 1 to 24 hours. The timer digits will flash for a few seconds on the unit's LED screen before it reverts back to displaying the humidity level. This indicates the timer has been set.
- ◆ The unit will now automatically operate on the selected settings for the chosen period of time, then turn itself off when it elapses.

## The Child Lock Function

This unit is equipped with a child lock function, which locks the control panel to prevent access to the unit's functions while it is in operation.

- ◆ Simultaneously long-press the Speed Selection and Timer buttons on the unit's control panel to activate the Child Lock function. There will be a sound prompt and the control panel will stop responding to any button presses.
- ◆ Simultaneously long-press the two buttons again while the Child Lock function is active to deactivate it. There will be a sound prompt, the corresponding indicator on the unit's LED display will go out, and the control panel will resume responding to any button presses as normal.



## Connecting to WiFi/Downloading The App

- ◆ To start using the 'BLACK+DECKER Home' app, begin by downloading it from the Apple App store or the Google Play store. Scan the QR Codes shown below to download the app directly from either store.
- ◆ Follow the instructions in the app to create an account and connect the dehumidifier to a WiFi network.

**Note:** Other app and device instructions are also available in the app.

- ◆ Once the app is downloaded, carry out the following steps to control the unit remotely through the corresponding smart device.



## Connecting the App to the Unit

- ◆ Install the "BLACK+DECKER Home" app and create a user account, as detailed above.
- ◆ Plug the appliance in and press and hold the Mode button for 3 seconds. The WiFi indicator will illuminate and begin to flash to show the unit is pairing.
- ◆ Place the appliance within 5 metres of your router
- ◆ As long as the power is turned on and the mode button has been pressed and held for 3 seconds, the Wifi indicator flashes. If there is no network configuration after 3 minutes, the status will be cancelled and the indicator light will go out. If you need to re-connect to WiFi, long press the Mode button for 5 seconds to start the network configuration. The WIFI indicator will flash again.

## WiFi Connection

The unit can be connected to WiFi in two different ways.

### Method 1/Bluetooth Connection

- ◆ Activate the Bluetooth function in the corresponding smart device.
- ◆ When the WIFI indicator flashes, open the 'BLACK+DECKER Home' app. The unit will automatically connect to the device via Bluetooth.

### Method 2

- ◆ When the WIFI indicator flashes, select 'Add Device'-'Home Appliances'-'Dehumidifer', and follow the instructions on the display.
- ◆ Check the status of the WIFI indicator and choose the correct status.
- ◆ If the WIFI indicator flashes rapidly, the unit can be connected to Bluetooth directly.
- ◆ If the WIFI indicator flashes slowly, press "Connect" to connect to the WIFI network named 'BLACK+DECKER Home'.

## Configuring Different SSD Bands for 2.4GHz and 5GHz

- ◆ If your router supports both the 2.4 GHz and 5 GHz bands, but only one Wi-Fi name is displayed on the Wi-Fi search page of your mobile phone, perform these steps:
  1. Go to the Wireless page of the router. (The entry address is usually provided on the label attached to the back of the router).
  2. Go to the 2.4 GHz setting page, and set the Wi-Fi name (SSID) to XXX—2.4G, where xxx indicates the Wi-Fi name. Save setting.
  3. Go to the 5 GHz setting page, and set the Wi-Fi name (SSID) to XXX—5G, where xxx indicates the Wi-Fi name. Save setting.
- ◆ When the preceding settings are complete, the new Wi-Fi names will Appear on the Wi-Fi settings page of your mobile phone.

**Note:** After the Wi-Fi names are changed, you need to reconnect the devices that use this wireless router. The password remains the same if it has not been changed.

## Using the App

Once the app is downloaded, carry out the following steps to control the unit remotely through the corresponding smart device.

- ◆ Tap the Power On/Off key on the app's main screen to turn the unit On or Off.

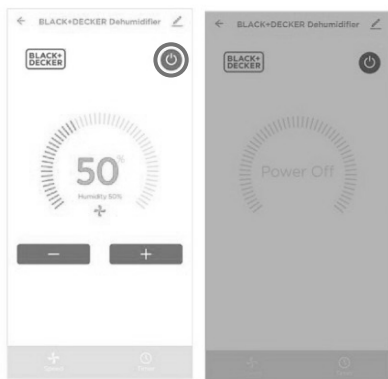

Power ON Screen    Power OFF Screen

- ◆ Tap the + and – keys on the app's main screen to increase or decrease the humidity levels. The current humidity level is displayed above the two keys.



- ◆ Tap the Speed key on the app's main screen to access the speed selection function, then tap either the Low or High speed keys to select and set the desired operation speed.



Speed key

High Speed key

- ◆ Tap the Timer key on the app's main screen to access the timer screen. In the new screen, click Add Timer to program and set a timer.



Timer key

Timer screen

- ◆ Tap the Mode key on the app's Speed Selection screen to switch between operational modes Ventilation, Dry Clothes, Auto and Continuous.

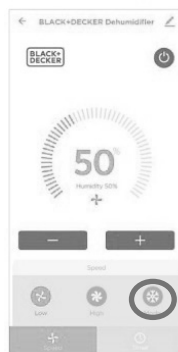

## Cleaning and maintenance

**⚠WARNING:** DO NOT IMMERSE THE UNIT, POWER CORD OR PLUG IN WATER OR ANY OTHER LIQUID.

**⚠WARNING:** Before cleaning and maintenance, switch the appliance off, unplug the adaptor from the appliance and remove the adaptor from the mains socket, to prevent electric shock.

- ◆ DO NOT immerse any part of the appliance, power cord or plug in liquids.
- ◆ Use a soft damp cloth to wipe the outer casing. Avoid using detergent, spray or chemicals as these may cause damage to the appliance.
- ◆ Use a dry cloth to wipe the control panel. DO NOT use water on the control panel.
- ◆ Use only implements recommended by the manufacturer for defrosting or cleaning.
- ◆ Dry the water tank with a soft cloth. DO NOT use an abrasive brush, as this might scratch the surface.
- ◆ Clean the water from inside the float. DO NOT take the float assembly apart.
- ◆ Once the tank has been cleaned, allow it to dry thoroughly before refitting it into the unit.

**Note:** DO NOT repair or disassemble the unit. In the unlikely event of the appliance developing fault seek advice from the manufacturer.

## Removing and Emptying the Water Tank

This unit is equipped with a removable water tank, for ease of cleaning.

- ◆ To clean the water tank, pull it out of the appliance, as shown in the figure below.
- ◆ Once the water tank is detached from the unit, pull out the handle.
- ◆ Empty the water tank by tipping it gently over a sink or drain.
- ◆ Once the water tank is fully empty, place it back into the unit.

**Note:** Ensure the water tank is firmly secured before attempting to use the unit, as the dehumidifier will not work otherwise.

**Note:** Alternatively, the water tank can be emptied by lifting the rubber cover on the drainage hole at the back of the unit, attaching the included hose to the opening and draining the contents onto a suitable container.

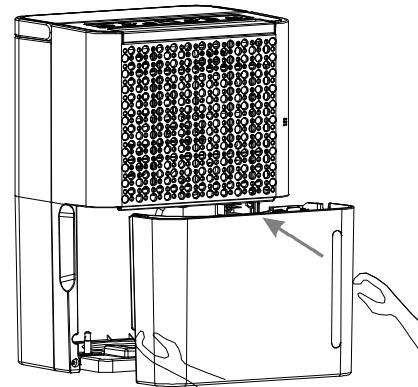
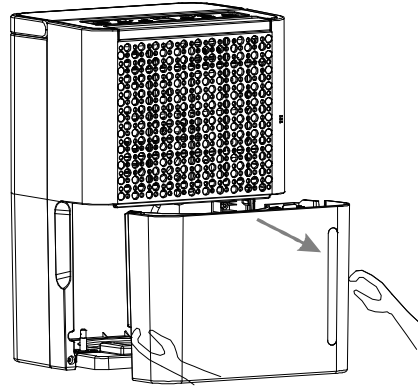

## Removing the Filter:

This unit is equipped with a removable washable filter.

- ◆ To clean the filter, simply pull it out of the unit, as shown in the figure below.
- ◆ Wash the filter under running water and leave it to dry thoroughly.
- ◆ Once the filter is thoroughly dry, place it back into the unit, ensuring it is firmly secured into place.
- ◆ The unit is now ready for normal use.

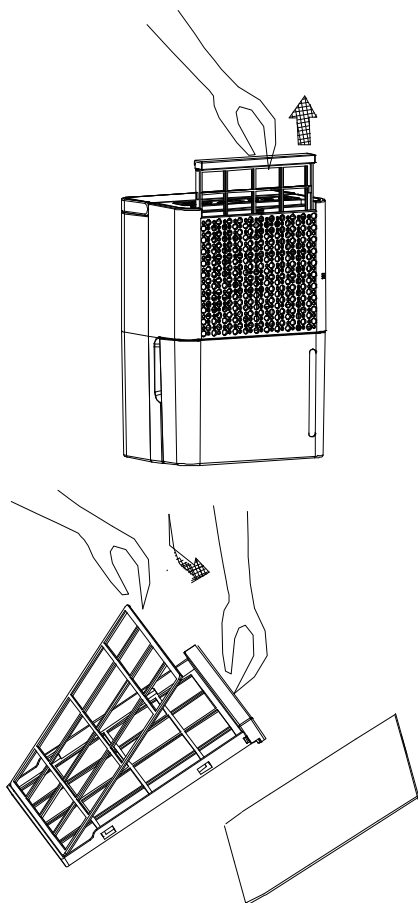

## To store your appliance:

- ◆ Ensure that the dehumidifier is cool, clean and dry before you store it.
- ◆ Store the appliance in a cool and dry place, out of the reach of children.

## ⚠WARNING: The following information is for qualified technicians ONLY to tend any problems with the BXEH60016GB

- ◆ Please DO NOT attempt to fix, repair or alter this product in any way unless you are fully qualified
  - ◆ If you are concerned or want any further advice please call 0333 220 6089 Instruction, Repairing Appliances Containing R290.
1. **Checks to the area** - prior to beginning work on systems containing flammable refrigerants, safety checks are necessary to ensure that the risk of ignition is minimised. For repair to the refrigerating system, the following precaution shall be completed prior to conducting work on the system.
  2. **Work procedure shall be undertaken** under a controlled procedure so as to minimise the risk of a flammable gas or vapour being present while the work is being performed.
  3. **General work area** - All maintenance staff and others working in the local area shall be instructed on the nature of work being carried out. Work in confined spaces shall be avoided.
  4. **Checking for presence of refrigerant** - The area shall be checked with an appropriate refrigerant detector prior to and during work, to ensure the technician is aware of potentially toxic or flammable atmospheres. Ensure that the leak detection equipment being used is suitable for use with all applicable refrigerants, i.e. nonsparking, adequately sealed or intrinsically safe.
  5. **Presence of fire extinguisher** - If any hot work is to be conducted on the refrigerating equipment or any associated parts, appropriate fire extinguishing equipment shall be available to hand. Have a dry powder or CO2 fire extinguisher adjacent to the charging area.
  6. **No ignition sources** - No person carrying out work in relation to a refrigerating system which involves exposing any pipe work shall use any sources of ignition in such a manner that it may lead to the risk of fire or explosion.

All possible ignition sources, including cigarette smoking, should be kept sufficiently far away from the site of installation, repairing, removing and disposal, during which refrigerant can possibly be released to the surrounding space. Prior to work taking place, the area around the equipment is to be surveyed to make sure that there are no flammable hazards or ignition risks. "No Smoking" signs shall be displayed.

7. **Ventilated area** - Ensure that the area is in the open or that it is adequately ventilated before breaking into the system or conducting any hot work. A degree of ventilation shall continue during the period that the work is carried out. The ventilation should safely disperse any released refrigerant and preferably expel it externally into the atmosphere.
8. **Checks to the refrigerating equipment** - Where electrical components are being changed, they shall be fit for the purpose and to the correct specification. At all times the manufacturer's maintenance and service guidelines shall be followed. If in doubt, consult the manufacturer's technical department for assistance. The following checks shall be applied to installations using flammable refrigerants:
  - ◆ The actual refrigerant charge is in accordance with the room size within which the refrigerant containing parts are installed;
  - ◆ The ventilation machinery and outlets are operating adequately and are not obstructed;
  - ◆ If an indirect refrigerating circuit is being used, the secondary circuit shall be checked for the presence of refrigerant;
  - ◆ Marking to the equipment continues to be visible and legible. Markings and signs that are illegible shall be corrected;
  - ◆ Refrigerating pipe or components are installed in a position where they are unlikely to be exposed to any substance which may corrode refrigerant containing components, unless the components are constructed of materials which are inherently resistant to being corroded or are suitably protected against being so corroded.
9. **Checks to electrical devices**
  - ◆ Repair and maintenance to electrical components shall include initial safety checks and component inspection procedures. If a fault exists that could compromise safety, then no electrical supply shall be connected to the

circuit until it is satisfactorily dealt with. If the fault cannot be corrected immediately but it is necessary to continue operation, an adequate temporary solution shall be used. This shall be reported to the owner of the equipment so all parties are advised. Initial safety checks shall include:

- ◆ That capacitors are discharged: this shall be done in a safe manner to avoid possibility of sparking;
  - ◆ That no live electrical components and wiring are exposed while charging, recovering or purging the system;
  - ◆ That there is continuity of earth bonding.
10. **Repairs to sealed components.**
    - ◆ During repairs to sealed components, all electrical supplies shall be disconnected from the equipment being worked upon prior to any removal of sealed covers, etc. If it is absolutely necessary to have an electrical supply to equipment during servicing, then a permanently operating form of leak detection shall be located at the most critical point to warn of a potentially hazardous situation.
    - ◆ Particular attention shall be paid to the following to ensure that by working on electrical components, the casing is not altered in such a way that the level of protection is affected. This shall include damage to cables, excessive number of connections, terminals not made to original specification, damage to seals, incorrect fitting of glands, etc.
    - ◆ Ensure that the apparatus is mounted securely. Ensure that seals or sealing materials have not degraded to the point that they no longer serve the purpose of preventing the ingress of flammable atmospheres.
    - ◆ Replacement parts shall be in accordance with the manufacturer's specifications.
  11. **Repair to intrinsically safe components**
    - ◆ DO NOT apply any permanent inductive or capacitance loads to the circuit without ensuring that this will not exceed the permissible voltage and current permitted for the equipment in use.
    - ◆ Intrinsically safe components are the only types that can be worked on while live in the presence of a flammable atmosphere. The test apparatus shall be at the correct rating.

- ◆ Replace components only with parts specified by the manufacturer. Other parts may result in the ignition of refrigerant in the atmosphere from a leak.
- 12. Cabling**
- ◆ Check that cabling will not be subject to wear, corrosion, excessive pressure, vibration, sharp edges or any other adverse environmental effects. The check shall also take into account the effects of aging or continual vibration from sources such as compressors or fans.
- 13. Detection of flammable refrigerants**
- ◆ Under no circumstances shall potential sources of ignition be used in the searching for or detection of refrigerant leaks. A halide torch (or any other detector using a naked flame) shall not be used.
  - ◆ Removal and evacuation
  - ◆ When breaking into the refrigerant circuit to make repairs – or for any other purpose – conventional procedures shall be used. However, for flammable refrigerants it is important that best practice is followed since flammability is a consideration. The following procedure shall be adhered to:
    - ◆ Remove refrigerant;
    - ◆ Purge the circuit with inert gas;
    - ◆ Evacuate;
    - ◆ Purge with inert gas;
    - ◆ Open the circuit by cutting or brazing.
  - ◆ The refrigerant charge shall be recovered into the correct recovery cylinders. For appliances containing flammable refrigerants the system shall be purged with oxygen-free nitrogen to render the appliance safe for flammable refrigerants. This process may need to be repeated several times.
  - ◆ Compressed air or oxygen shall not be used for purging refrigerant systems.
  - ◆ For appliances containing flammable refrigerants, refrigerants purging shall be achieved by breaking the vacuum in the system with oxygen-free nitrogen and continuing to fill until the working pressure is achieved, then venting to atmosphere, and finally pulling down to a vacuum. This process shall be repeated until no refrigerant is within the system. When the final oxygen-free nitrogen charge is used, the system shall be vented down to atmospheric pressure to enable work to take

place. This operation is absolutely vital if brazing operations on the pipe-work are to take place.

- ◆ Ensure that the outlet for the vacuum pump is not close to any potential ignition sources and that ventilation is available.

**14. Charging procedures**

In addition to conventional charging procedures, the following requirements shall be followed.

- ◆ Ensure that contamination of different refrigerants does not occur when using charging equipment.
- ◆ Hoses or lines shall be as short as possible to minimise the amount of refrigerant contained in them.
- ◆ Cylinders shall be kept in an appropriate position according to the instructions.
- ◆ Ensure that the refrigerating system is earthed prior to charging the system with refrigerant.
- ◆ Label the system when charging is complete (if not already).
- ◆ Extreme care shall be taken not to overfill the refrigerating system.
- ◆ Prior to recharging the system, it shall be pressure-tested with the appropriate purging gas. The system shall be leaktested on completion of charging but prior to commissioning. A follow up leak test shall be carried out prior to leaving the site.

**15. Decommissioning**

- ◆ Before carrying out this procedure, it is essential that the technician is completely familiar with the equipment and all its detail. It is recommended good practice that all refrigerants are recovered safely.
- ◆ Prior to the task being carried out, an oil and refrigerant sample shall be taken in case analysis is required prior to re-use of recovered refrigerant. It is essential that electrical power is available before the task is commenced.
- a. Become familiar with the equipment and its operation.
- b. Isolate system electrically.
- c. Before attempting the procedure, ensure that:
  - ◆ Mechanical handling equipment is available, if required, for handling refrigerant cylinders;
  - ◆ All personal protective equipment is available and being used correctly;

- ◆ The recovery process is supervised at all times by a competent person;
- ◆ Recovery equipment and cylinders conform to the appropriate standards.
- d. Pump down refrigerant system, if possible.
- e. If a vacuum is not possible, make a manifold so that refrigerant can be removed from various parts of the system.
- f. Make sure that cylinder is situated on the scales before recovery takes place.
- g. Start the recovery machine and operate in accordance with instructions.
- h. DO NOT overfill cylinders (no more than 80% volume liquid charge).
- i. DO NOT exceed the maximum working pressure of the cylinder, even temporarily.
- j. When the cylinders have been filled correctly and the process completed, make sure that the cylinders and the equipment are removed from site promptly and all isolation valves on the equipment are closed off.
- k. Recovered refrigerant shall not be charged into another refrigerating system unless it has been cleaned and checked.

#### 16. Labelling

- ◆ Equipment shall be labelled stating that it has been de-commissioned and emptied of refrigerant. The label shall be dated and signed. For appliances containing flammable refrigerants, ensure that there are labels on the equipment stating the equipment contains flammable refrigerant.

#### 17. Recovery

- ◆ When removing refrigerant from a system, either for servicing or decommissioning, it is recommended good practice that all refrigerants are removed safely.
- ◆ When transferring refrigerant into cylinders, ensure that only appropriate refrigerant recovery cylinders are employed. Ensure that the correct number of cylinders for holding the total system charge is available. All cylinders to be used are designated for the recovered refrigerant and labelled for that refrigerant (i.e. special cylinders for the recovery of refrigerant). Cylinders shall be complete with pressure-relief valve and associated shut-off valves in good working order. Empty recovery cylinders are evacuated and, if possible, cooled before recovery occurs.

- ◆ The recovery equipment shall be in good working order with a set of instructions concerning the equipment that is at hand and shall be suitable for the recovery of all appropriate refrigerants including, when applicable, flammable refrigerants. In addition, a set of calibrated weighing scales shall be available and in good working order. Hoses shall be complete with leak-free disconnect couplings and in good condition. Before using the recovery machine, check that it is in satisfactory working order, has been properly maintained and that any associated electrical components are sealed to prevent ignition in the event of a refrigerant release. Consult manufacturer if in doubt.
- ◆ The recovered refrigerant shall be returned to the refrigerant supplier in the correct recovery cylinder, and the relevant waste transfer note arranged. DO NOT mix refrigerants in recovery units and especially not in cylinders. If compressors or compressor oils are to be removed, ensure that they have been evacuated to an acceptable level to make certain that flammable refrigerant does not remain within the lubricant. The evacuation process shall be carried out prior to returning the compressor to the suppliers. Only electric heating to the compressor body shall be employed to accelerate this process. When oil is drained from a system, it shall be carried out safely.

#### Protecting the environment



Separate collection. Products and batteries marked with this symbol must not be disposed of with normal household waste.

Remember the environment when disposing of packaging around the appliance and when the appliance is no longer required.

Products and batteries contain materials that can be recovered or recycled, reducing demand for raw materials. Please recycle electrical products and batteries according to local provisions. Further information is available at [www.2helpU.com](http://www.2helpU.com).

**Technical data**

		BXEH60016GB
Input voltage	V AC	220-240
Frequency	Hz	50
Power input	W	250
Water Tank Capacity	L	2.1
Weight	KG	10
Dimensions	CM	H 40.5 x W 27 x D 20.5

**Product Guarantee**

This product comes with a 2 Year guarantee from the original date of purchase. If any defect arises due to faulty materials of workmanship, the faulty products must be returned to the place of purchase. Refund or replacement is at the discretion of the retailer. This guarantee is in addition to and in no way prejudices your statutory rights.

**The Following Conditions Apply:**

- ◆ The product must be returned to the retailer with proof of purchase or a receipt within the 1st year of purchase. For any product related issues after 12 months please contact our customer services team.
- ◆ The product must be installed and used in accordance with the instructions contained in this instruction guide.
- ◆ It must be used only for domestic purposes.
- ◆ It does not cover wear and tear, damage, misuse or consumable parts.
- ◆ This guarantee is valid in the UK and Republic of Ireland.

**Product Security and Telecommunications Infrastructure (PSTI)**

Your Black+Decker 12L Smart Dehumidifier is an interconnected product which uses both wifi and Bluetooth to connect to the BLACK+DECKER Home App. As more devices in the home become connected to the internet, cyber security of the Internet of Things (IoT) is increasingly important to protect end users.

The Black+Decker 12L Smart Dehumidifier will deliver an updated experience on a regular basis including security patches. It is strongly recommended for best performance and security that all maintenance updates should be accepted as soon as possible. The 12L Smart Dehumidifier will continue to update until the specified date found within the Software Update website address. Please note updates may well continue after the date but it is likely that they will be less frequent. For further information please visit the below links.

For Security Reporting, Black+Decker actively tries to identify and reduce potential vulnerabilities during the products lifetime and in this effort we value input on actual or potential vulnerabilities reported by yourself.

If you believe you have discovered a vulnerability in a Black+Decker product please follow the Security Report website address below and follow the steps to complete the Security Reporting Form. Further information regarding the process is referenced on our website.

**Security Reporting Website Address:**

[www.rkw ltd.com/#/security-reporting](http://www.rkw ltd.com/#/security-reporting)

**Software Updates Website Address:**

[www.rkw ltd.com/#/software-updates](http://www.rkw ltd.com/#/software-updates)



**For all customer service enquires please contact us below;**

RKW,

Sutton House,

Berry Hill Road,

Stoke-on-Trent,

ST4 2NL

Email [blackanddecker@rkwltd.com](mailto:blackanddecker@rkwltd.com)

Tel 0333 220 6089

Black & Decker® and BLACK+DECKER™ and the Black & Decker® and BLACK+DECKER™ logos are registered trademarks of The Black & Decker® Corporation and are used under licence. All rights reserved. Imported and Distributed by RKW LTD, Sutton House, Berry Hill Industrial Estate, Berry Hill Road, Stoke-on-Trent, ST4 2NL

ENGLISH

(Original instructions)

(Original instructions)

ENGLISH



ENGLISH

(Original instructions)