

This product is only suitable for well-insulated spaces or occasional use.

www.blackanddecker.co.uk

BXCV41014GB

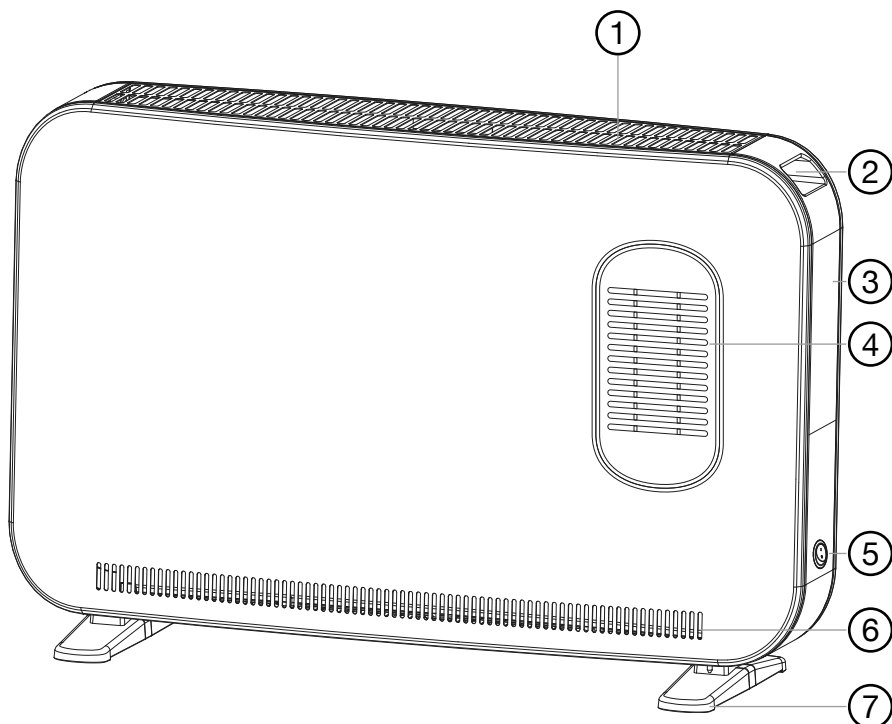

What's in the box

Instruction Manual
Convection Heater
Remote Control
Feet
Screws

Features

1. Air Outlet
2. Handle
3. Control panel
4. Turbo air outlet
5. On/Off switch
6. Air inlet
7. Feet

Control Panel

1. LED display
2. Remote control sensor
3. Mode key
4. Power On/Off key
5. Time/Temperature + key

6. Time/Temperature + key
7. Timer selection key
8. Turbo Fan key

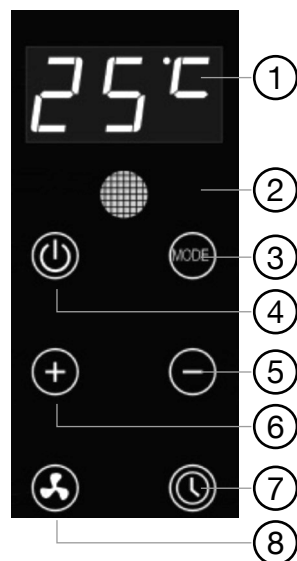

Intended Use

Your BLACK+DECKER BXC41014GB 2.2KW Smart Convection Heater has been designed for heating small and medium spaces.

This appliance is intended for indoor household use only.

Thank you for choosing BLACK+DECKER. We hope that you will enjoy using this product for many years.

Safety Instructions

⚠ WARNING: Read all safety warnings and all instructions. Failure to follow the warnings and instructions listed below may result in electric shock, fire and/or serious injury.

- ◆ Read this manual carefully before using the appliance.
- ◆ Retain this manual for future reference.
- ◆ The intended use is described in this manual.
- ◆ The use of any accessory or attachment or the performance of any operation with this appliance other than those recommended in this instruction manual may present a risk of personal injury.
- ◆ Remove the unit from its packaging and check to ensure it is in good condition before using.
- ◆ Do not let children play with parts of the packing (such as plastic bags).

⚠ WARNING: When using mains powered appliances, basic safety precautions, including the following, should always be followed to reduce the risk of fire, electric shock, personal injury and material damage.

Using Your Appliance

Please read the operating instructions carefully before using your heater for the first time.

- ◆ Check that the voltage of the main circuit corresponds with the rating of the appliance before operating.
- ◆ The heater must not be located immediately below a socket outlet.
- ◆ The appliance air inlet and outlet openings must not be obstructed in any way.
- ◆ In order to avoid overheating, do not cover the heater.
- ◆ Do not use this heater in the immediate surroundings of a bath, a shower or a swimming pool.
- ◆ Never move the heater during operating, always unplug heater when not in use.
- ◆ Never use the appliance if the appliance or cable is damaged. The appliance may only be opened up and repaired by authorised qualified personnel.
- ◆ The appliance is not to be used by persons (including children) with reduced physical, sensory or mental capabilities, or lack of experience and knowledge, unless they have been given supervision or instruction.

- ◆ Children of less than 3 years should be kept away unless continuously supervised.
- ◆ Children aged from 3 years and less than 8 years shall only switch on/off the appliance provided that it has been placed or installed in its intended normal operating position and they have been given supervision or instruction concerning use of the appliance in a safe way and understand the hazards involved. Children aged from 3 years and less than 8 years shall not plug in, regulate and clean the appliance or perform user maintenance.
- ◆ **▲CAUTION:** Some part of this product can become very hot and cause burns. Particular attention has to be given where children and vulnerable people are present.
- ◆ Close supervision is necessary when the product is used by or near children or infirm persons.
- ◆ Do not allow children to play with the appliance.
- ◆ Do not let the cable hang over the edge of a table or counter or let it come into contact with any hot surfaces.
- ◆ Before use ensure the cable is fully extended and is not in contact with any part of the heater.
- ◆ Do not pull the plug out by the cable as this may damage the plug and/or the cable.
- ◆ Do not carry the appliance by the power cable.
- ◆ Do not use this product for anything other than its intended use.
- ◆ This appliance is for normal household use only.
- ◆ **FOR INDOOR USE ONLY.** Do not use the appliance outdoors.
- ◆ Do not operate with wet hands.
- ◆ Do not leave the appliance unattended when switched on.
- ◆ The use of accessory attachments is not recommended by the appliance manufacturer. Use of an extension cable with this appliance is not recommended. However, if it is necessary to use an extension lead, ensure that the lead is suited to the power consumption of the appliance to avoid overheating of extension cable, appliance or plug point. Do not place the extension cable in a position where it can be pulled on by children or animals or tripped over.
- ◆ Ensure that no other high current appliances are plugged into the same circuit with your heater as an overload can occur.
- ◆ Always unplug the appliance when not in use or before cleaning.
- ◆ Do not operate any product with a damaged cable or plug, or after the product malfunctions, or is dropped or appears damaged in any way. Return the complete product to the place of purchase for inspection, repair or replacement.

- ◆ The manufacturer does not accept responsibility for any damage or injury caused by improper or incorrect use, or for repairs carried out by unauthorised personnel.

Safety Of Others

- ◆ Close supervision is necessary when any appliance is used by or near children.
- ◆ Children should not play with the appliance.
- ◆ Cleaning and user maintenance should not be undertaken by children without supervision.
- ◆ Take care when any appliance is used near pets.
- ◆ Do not allow the cable to become twisted or come into contact with children.

After Use

- ◆ While cleaning, DO NOT use a wet cloth or use water on any part of the unit, as this may cause a short circuit or electrical shock.
- ◆ Keep this unit clean. Do not allow objects to enter the ventilation opening as this may cause electric shock, or damage to the unit. Switch off at the wall socket then remove the plug from the socket when not in use or before cleaning.
- ◆ Check all inlets and outlets from time to time for accumulated dust.

- ◆ Disconnect the unit from mains outlet when it is not in use, or before relocating or cleaning it.
- ◆ Switch off, remove the plug from the socket and let the appliance cool down before leaving it unattended and before changing, cleaning or inspecting any parts of the appliance.
- ◆ When not in use, the appliance should be stored in a dry place. Children should not have access to stored appliances.

Inspections And Repairs

- ◆ Do not attempt to dismantle, repair or remould any part of the unit. This should only be done by a qualified service agent. Even the change of power cable should be done by a qualified person.
- ◆ In the unlikely event the appliance develops a fault, stop using it immediately and seek advice from the manufacturer.
- ◆ In case of technical problems, switch off the product and do not attempt to repair it yourself. Return the appliance to an authorised service facility for examination, adjustment or repair. Always insist on the use of original spare parts. Failure to comply with the above mentioned precautions and instructions, could affect the safe operation of this product.

Additional Safety Instructions for This Appliance

- ◆ Install the unit on flat and hard floor to diminish vibration or noise.
- ◆ Always operate the appliance on a smooth, even, stable surface. Do not place the unit on a hot surface.
- ◆ Arrange the cable such that it is not a trip hazard.
- ◆ Ensure that the unit is switched off after use.
- ◆ Do not immerse cables, plugs or any part of the appliance in water or any other liquid.
- ◆ Operate the unit only at the voltage specified.
- ◆ Do not use the unit near open windows, as contact with rain and other natural elements could cause an electrical hazard.
- ◆ Do not put heavy objects on the appliance.
- ◆ Do not tip the unit on its side.
- ◆ Never insert any other object into the unit body to avoid any hazard or unit failure.
- ◆ Do not put the unit close to heat-generating devices or near flammable and dangerous materials.
- ◆ Do not use near or point the heater towards furniture, animals, curtains or other inflammable objects. Keep combustible materials, such as furniture and bedding, at least 1 metre from the front, sides, and rear of the heater.
- ◆ Do not place the cord under carpet, rugs or furniture.
- ◆ If the supply cable is damaged, it must be replaced by the manufacturer or its service agent or a similarly qualified person in order to avoid a hazard.
- ◆ For optimal airflow circulation, leave a distance of at least 1 metre around the appliance on every side.
- ◆ Always direct the airflow in order to optimise heating. Avoid corners, small objects and other surfaces or objects which may impede the airflow.
- ◆ The appliance must be positioned so that the plug is accessible.
- ◆ Always turn the heater off and unplug it from the mains before attempting to move it. Due to the presence of hot parts, hold the heater only by the handle provided.

⚠WARNING: Do not place the unit on or near a hot gas electric burner.

Information regarding substances of very high concern (SVHC) according to the Regulation 1907/2006/EC (REACH).

- ◆ This product contains Lead, (substance SVHC), CAS Number: 7439-92-1 and Cadmium (substance SVHC), CAS number: 7440-43-9

Electrical safety

Before use, check that the mains voltage corresponds to the voltage on the rating plate.



Always check that the mains voltage corresponds to the voltage on the rating plate..

- ◆ Appliance plugs must match the outlet. Never modify the plug in any way.
- ◆ Do not use any adapter plugs with this appliance. Unmodified plugs and matching outlets will reduce the risk of electric shock.
- ◆ To avoid the risk of electric shock, do not immerse the cord, plug or appliance in water or other liquid.

Extension cables

- ◆ Up to 30m (100 ft) can be used without loss of power.
- ◆ If the supply cord is damaged, it must be replaced by the manufacturer or an authorised BLACK+DECKER Service Centre in order to avoid a hazard.

Labels on Appliance

The following pictograms along with the date code are shown on the appliance:



▲WARNING: Hot surface



▲WARNING: Do not cover

▲WARNING: Before assembling, switch the appliance off and remove the plug from the socket.

Features

1. Air Outlet
2. Handle
3. Control panel
4. Turbo air outlet
5. On/Off switch
6. Air inlet
7. Feet

Control Panel

1. LED display
2. Remote control sensor
3. Mode key
4. Power On/Off key
5. Time/Temperature – key
6. Time/Temperature + key
7. Timer selection key
8. Turbo Fan key

Use

About the Controls

- ◆ 3 heat settings
- ◆ Turbo Fan
- ◆ Adjustable 24H timer
- ◆ Smart WiFi functionality

Inserting the Batteries

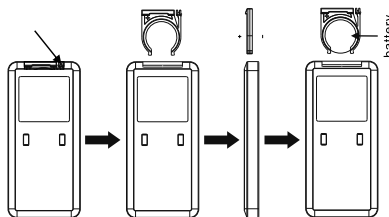

This unit can be operated through its built-in control panel or through the included remote control.

Important: Follow the instructions of use and the recycle rules given on the battery packaging.

- ◆ The remote control requires 1 CR2025 3V lithium battery (not included).
- ◆ Open the battery compartment by pushing the locking tab to one side, then sliding the cover down.
- ◆ There is a tab on the battery cover which must be pressed to one side before it can be removed.
- ◆ Insert the battery into the compartment, observing the polarity in the diagram (see below drawing).
- ◆ Close the battery compartment.

NOTE: Ensure the battery cover is firmly secured into place before attempting to use the remote.

- ◆ Your remote control is now ready for use.

⚠ WARNING: DO NOT INGEST BATTERY; CHEMICAL BURN HAZARD. This product contains a coin/button cell battery. If the coin/button cell battery is swallowed, it can cause severe internal burns in just 2 hours and can lead to death.

- ◆ Keep new and used batteries away from children. If the battery compartment does not close securely, stop using the product and keep it away from children.
- ◆ If you think batteries might have been swallowed or placed inside any part of the body, seek immediate medical attention.
- ◆ If the coin cell battery contents come into contact with the skin, immediately wash area with mild soap and water. If coin cell battery liquid gets into the eye, rinse water over the open eye for 15 minutes or until irritation ceases. If medical attention is needed, the battery electrolyte is composed of an organic solvent and lithium salts.

Do not incinerate or dispose of appliance together with household waste material! Appliances that have reached the end of their life must be collected separately and returned to an environmentally compatible recycling facility.

Installing the Feet

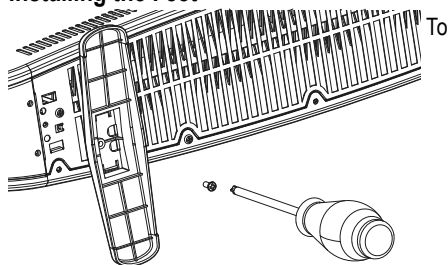

use the convection heater, start by installing the feet.

- ◆ To install the feet, turn the heater upside down and locate the foot notches at either end of the base.
- ◆ Align the two tabs in each of the foot brackets with the corresponding notches on the base of the unit, then push them in until they click into place.
- ◆ Once the two feet are correctly secured into place, thread one of the included screws through each of the corresponding screw-holes on the foot brackets.

Ensure the feet are correctly positioned before attempting to use the unit. The feet are correctly installed if the two screws on the base of the unit sit flush inside the two U-shaped sections of each foot bracket, and the screw-hole on each of the brackets is facing outwards.

Turning the Unit On or Off

- ◆ To power the unit on, plug it into a compatible mains socket and push the On/Off switch to the 'On' position, represented by the symbol 'I'. The Power On/Off key will illuminate.
- ◆ Once the unit is switched on, press the Power On/Off key on the remote control or the unit's control panel. The control panel will illuminate.
- ◆ Press this key again when the unit is in operation to put it into Standby mode. The control panel will go out, but the Power On/Off key will remain lit.
- ◆ To turn the unit off completely, push the On/Off switch down to the 'Off' position, represented by the symbol 'I'.
- ◆ **⚠ WARNING:** DO NOT touch the grille while the heater is in operation, as it will be very hot and there will be a risk of burns.
- ◆ **⚠ WARNING:** DO NOT store the unit directly after turning it off. Allow for time for the unit to cool down before storing.

Mode Selection

- ◆ This heater offers a choice of 3 heat settings - Low (1), Medium (2) and High (3).
- ◆ Press the Mode key on the remote control or the unit's control panel to cycle through and select the available heating modes. The corresponding digit will be displayed on the unit's LED screen, and the unit will automatically adjust to the selected mode within a few seconds.
- ◆ Press this key again at any time to switch to a different heating mode.

Note! The unit's default working mode is High (3).

Temperature Control

- ◆ This heater is equipped with an adjustable thermostat, which allows for temperature control within each of the 3 heat settings.
- ◆ Press the Mode Selection key on the unit's control panel to activate the corresponding function. The '+' and '-' keys on the unit's control panel will illuminate to show this function has been activated.
- ◆ Once the Temperature Selection function is active, use the + and – keys on the remote control or the unit's control panel to increase or lower the heating temperature by increments of 1, from 7 to 35 degrees. Press the '+' key to increase the temperature, or the '-' key to decrease it.

Note! The unit's default working temperature is 24 degrees.

Setting a Timer

- ◆ This heater is equipped with a 24-hour timer.
- ◆ Press the Timer key on the unit's control panel to activate the corresponding function. The '+' and '-' keys on the unit's control panel will illuminate to show this function has been activated.
- ◆ Once the Timer function is active, use the + and – keys on the remote control or the unit's control panel to increase or lower timer duration by increments of 1, from 1 to 24 hours. Press the '+' key to increase the duration of the timer, or the '-' key to decrease it.

The Turbo Function

This heater is equipped with a Turbo fan function, for faster operation.

- ◆ Press the Turbo fan key on the unit's control panel to activate the Turbo fan function.
- ◆ Press this key again while the Turbo function is in operation to stop this function. The heater will now operate at the normal speed again.

Connecting to WiFi/Downloading The App

- ◆ To start using the 'BLACK+DECKER Home' app, begin by downloading it from the Apple App store or the Google Play store. Scan the QR Codes shown below to download the app directly from either store.
- ◆ Follow the instructions in the app to create an account and connect the heater to a WiFi network.

Note: Other app and device instructions are also available in the app.

- ◆ Once the app is downloaded, carry out the following steps to control the unit remotely through the corresponding smart device.



Connecting the App to the Unit

- ◆ Install the "BLACK+DECKER Home" app and create a user account, as detailed above.
- ◆ Plug the appliance in and long-press the Start/Pause/WiFi button to activate the WiFi function.
- ◆ Place the appliance within 5 metres of your router.
- ◆ As long as the Start/Pause/WiFi button has been pressed, the WIFI indicator flashes. If there is no network configuration after 3 minutes, the status will be cancelled and the indicator light will go out. If you need to re-connect to WIFI, long press the Start/pause/wifi button for 5 seconds to start the network configuration. The WIFI indicator flashes again.

WiFi Connection

The unit can be connected to WiFi in two different ways.

Method 1/Bluetooth Connection

- ◆ Activate the Bluetooth function in the corresponding smart device.
- ◆ When the WIFI indicator flashes, open the 'BLACK+DECKER Home' app. The unit will automatically connect to the device via Bluetooth

Method 2

- ◆ When the WIFI indicator flashes, select 'Add Device'-'Home Appliances'-'Heater', and follow the instructions on the display.
- ◆ Check the status of the WIFI indicator and choose the correct status.

- ◆ If the WIFI indicator flashes rapidly, the unit can be connected to Bluetooth directly.
- ◆ If the WIFI indicator flashes slowly, press "Connect" to connect to the WIFI network named 'BLACK+DECKER Home'.

Configuring Different SSD Bands for 2.4GHz and 5GHz

- ◆ If your router supports both the 2.4 GHz and 5 GHz bands, but only one Wi-Fi name is displayed on the Wi-Fi search page of your mobile phone, perform these steps:
 1. Go to the Wireless page of the router. (The entry address is usually provided on the label attached to the back of the router).
 2. Go to the 2.4 GHz setting page, and set the Wi-Fi name (SSID) to XXX—2.4G, where xxx indicates the Wi-Fi name. Save setting.
 3. Go to the 5 GHz setting page, and set the Wi-Fi name (SSID) to XXX—5G, where xxx indicates the Wi-Fi name. Save setting.
- ◆ When the preceding settings are complete, the new Wi-Fi names will appear on the Wi-Fi settings page of your mobile phone.

Note: After the Wi-Fi names are changed, you need to reconnect the devices that use this wireless router. The password remains the same if it has not been changed.

Using the App

Once the app is downloaded, carry out the following steps to control the unit remotely through the corresponding smart device.

- ◆ Tap the Power On/Off key on the app's main screen to turn the unit On or Off.
- ◆ Tap the + and – keys on the app's main screen to increase or decrease the temperature levels. The current temperature level is displayed above the two keys.
- ◆ Tap the Turbo Fan key on the app's main screen to access the On/Off selection function
- ◆ Tap the Timer key on the app's main screen to access the timer screen. In the new screen, click Add Timer to program and set a timer.
- ◆ Tap the Mode key on the app's Selection screen to switch between heat setting 1-3

Cleaning and maintenance

▲WARNING: Before cleaning and maintenance, switch the appliance off and remove the plug from the socket, to prevent electric shock.

- ◆ Do not immerse any part of the appliance, power cord or plug in liquids.
- ◆ Use a soft damp cloth to wipe the surface. Avoid using detergent, spray or chemicals as these may cause damage to the appliance.
- ◆ **▲WARNING:** DO NOT allow water or steam to enter any part of the appliance, as this could cause it to malfunction.
- ◆ Store the appliance in a cool, dry place, ideally in its original packaging.

Mains plug replacement

If a new mains plug needs to be fitted:

- ◆ Safely dispose of the old plug.
- ◆ Connect the brown lead to the live terminal in the new plug.
- ◆ Connect the blue lead to the neutral terminal.
- ◆ If the product is class I (earthed), connect the green/yellow lead to the earth terminal.

Note! If your product is class II double insulated (only 2 wires in the cord set), no connection is to be made to the earth terminal.

Follow the fitting instructions supplied with good quality plugs. Any replacement fuse must be of the same rating as the original fuse supplied with the product.

▲WARNING: The above section on mains plug replacement is for authorized service centre persons.

Protecting the environment



Separate collection. Products and batteries marked with this symbol must not be disposed of with normal household waste.

Products and batteries contain materials that can be recovered or recycled, reducing demand for raw materials. Please recycle electrical products and batteries according to local provisions. Further information is available at www.2helpU.com.

Technical data

		BXCV41014GB
Input voltage	V AC	220 - 240
Frequency	Hz	50-60
Power input	W	2200W
Weight	KG	3.9

Product Guarantee

This product comes with a 2 Year guarantee from the original date of purchase. If any defect arises due to faulty materials of workmanship, the faulty products must be returned to the place of purchase. Refund or replacement is at the discretion of the retailer. This guarantee is in addition to and in no way prejudices your statutory rights.

The Following Conditions Apply:

- ◆ The product must be returned to the retailer with proof of purchase or a receipt within the 1st year of purchase. For any product related issues after 12 months please contact our customer services team.
- ◆ The product must be installed and used in accordance with the instructions contained in this instruction guide.
- ◆ It must be used only for domestic purposes.
- ◆ It does not cover wear and tear, damage, misuse or consumable parts.
- ◆ This guarantee is valid in the UK and Republic of Ireland.

Product Security and Telecommunications Infrastructure (PSTI)

Your Black+Decker 2.2KW Smart Convection Heater is an interconnected product which uses both wifi and Bluetooth to connect to the BLACK+DECKER Home App. As more devices in the home become connected to the internet, cyber security of the Internet of Things (IoT) is increasingly important to protect end users.

The Black+Decker 2.2KW Smart Convection Heater will deliver an updated experience on a regular basis including security patches. It is strongly recommended for best performance and security that all maintenance updates should be accepted as soon as possible. The 2.2KW Smart Convection Heater will continue to update until the specified date found within the Software Update website address. Please note updates may well continue after the date but it is likely that they will be less frequent.

For further information please visit the below links.

For Security Reporting, Black+Decker actively tries to identify and reduce potential vulnerabilities during the products lifetime and in this effort we value input on actual or potential vulnerabilities reported by yourself.

If you believe you have discovered a vulnerability in a Black+Decker product please follow the Security Report website address below and follow the steps to complete the Security Reporting Form. Further information regarding the process is referenced on our website.

Security Reporting Website Address:

www.rkw ltd.com/#security-reporting

Software Updates Website Address:

www.rkw ltd.com/#software-updates

For all customer service enquires please contact us below;

RKW,
Sutton House,
Berry Hill Road,
Stoke-on-Trent,
ST4 2NL

Email blackanddecker@rkw ltd.com

Tel 0333 220 6089

Black & Decker® and BLACK+DECKER™ and the Black & Decker® and BLACK+DECKER™ logos are registered trademarks of The Black & Decker® Corporation and are used under licence. All rights reserved. Imported and Distributed by RKW LTD, Sutton House, Berry Hill Industrial Estate, Berry Hill Road, Stoke-on-Trent, ST4 2NL

Model Identifier(s): BXCv41014GB					
Item	Symbol	Value	Unit	Item	Unit
Heat Output				Type of heat input for electric storage, local space heaters only (select one)	
Nominal heat output	P _{nom}	1.83-2.18	kW	Manual heat charge with integrated thermostat	No
Minimum heat output (indicative)	P _{min}	0.85	kW	Manual heat charge control with room and/or outdoor temperature feedback	No
Maximum continuous heat output	P _{max, c}	2.18	kW	Electronic heat charge control with room and/or outdoor temperature feedback	No
Auxiliary electricity consumption				Fan assisted heat output	No
At nominal heat output	el _{max}	N/A	kW	Type of heat output/room temperature control (select one)	
At minimum heat output	el _{min}	N/A	kW	Single stage heat output and no room temperature control	No
In standby mode	el _{SB}	0.00016	kW	Two or more manual stages, no room temperature control	No
				With mechanic thermostat room temperature control	No
				With electronic room temperature control	Yes
				Electronic room temperature control plus day timer	No
				Electronic room temperature control plus week timer	No
				Other control options (multiple selections possible)	
				Room temperature control with presence detection	No
				Room temperature control with open window detection	No
				With distance control option	No
				With adaptive start control	No
				With working time limitation	Yes
				With black bulb sensor	No
Contact Details:	RKW LTD, Sutton House, Berry Hill Industrial Estate, Berry Hill Road, Stoke-on-Trent, ST4 2NL				